

# Douglas County Community and Senior Center



## The Douglas County Community and Senior Center

Located at 1329 Waterloo Lane, Gardnerville, NV 89410

In Herbig Park across the street from Lampe Park and next to the Carson Valley Skate Board Park

Anticipated Opening April 2015

Construction contract cost \$16.9 million which includes \$14.5 million for the actual building construction  
Square footage 83,000 sq. ft.

### Amenities

#### Gymnasium and fitness facility includes:

- Two regulation basketball courts
- Four regulation volleyball courts
- Two regulation racquetball courts
- Future rockclimbing wall
- Games lounge
- Three Lane suspended jogging track
- Cardio equipment, machine weights and free weights
- Concession
- Showers and lockers

#### Community Center Facility includes:

- Five multipurpose activity rooms
- Two arts and crafts activity rooms
- Community kitchen facilities
- Restrooms
- Children's preschool with outdoor play area
- Senior Day Care facility
- Community Health Nurse offices and clinic
- Covered patio and landscaped area with view of Job's Peak
- Community Services, Recreation and Senior Services administrative offices.

#### Senior Center facility includes:

- Dining room and event area seating for 300
- Dining room stage
- Dining room warming kitchen for event catering area
- Full commercial kitchen
- Restrooms
- Family restrooms
- Conference room
- Gift shop
- Lounge and waiting area
- Two covered patios one with the views of Job Peak



For more information contact  
Douglas County Community Services at 775-782-9828





# HERBIG PARK

## DOUGLAS COUNTY COMMUNITY & SENIOR CENTER

WATERLOO LANE, GARDNERVILLE, NV 89410

LEVEL 2

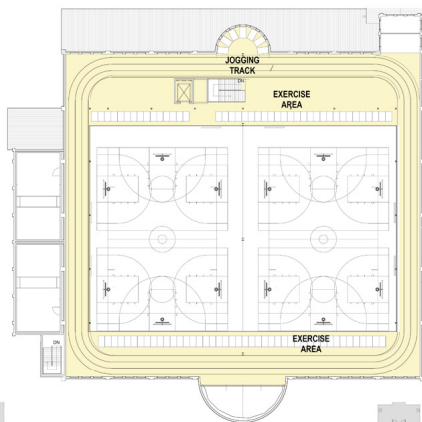

- Interesting information
- The building is constructed with over 250,000 bricks
- It will have 48 toilets
- It has over 7 miles of conduit and pipe
- It contains 152 doors
- It has 218 parking spaces
- It can be operated with as little as two staff
- It is designed to capture beautiful ranch and mountain views
- It maximizes natural light and passive solar heat
- It is designed to meet family needs of all ages
- It will be a hub for public transportation

LEVEL 1

